

## Technical characteristics

**TEK Range:**

Swivel chairs with or without headrests and 4-leg guest chairs.

**Swivel chairs:****Controls:**

Made of injection moulded plastic, black RAL 9005.

**Backrest:**

Black PA and polished aluminium frame that acts as a stretching frame for the open mesh fabric, made of 25% polyester and 25% elastomer, that adapts to the user's back and provides ventilation.

**Height and depth adjustable lumbar support:**

The swivel chairs are equipped with 6 cm height and depth adjustable lumbar support.

**Synchronised mechanism:**

Seat with synchronised mechanism, multi-positional lock along full adjustment and non-return system.

**Tension control**

Movement tension control for body weights of between 40 to 130 kg.

**Seat height control:**

Safety gas spring in black RAL 9005 finish for smooth height adjustment of the seat. The seat has a 10 cm adjustment range.

**Seat depth control:**

6 cm depth control mechanism.

**Seat:**

Moulded polyurethane foam seat, density 30 kg/m<sup>3</sup>.  
The seat is upholstered in fabrics from the Coinma collection.

**Arms:**

3D arms, pivoting and height adjustment. PP arm with height control button and PU padded armrests for user comfort.  
Height adjustable over a span of 8.5 cm, up to 30° pivot angle.

**Base:**

Cast aluminium base with five 350 mm spokes, chrome effect finish.

**Wheels:**

Black, self-braking PU/PA casters, complying with EN 12529 Standard, with soft surface for hard floors or optional hard surface for carpeted floors at no extra charge.

**Headrest:**

Ergonomic, adjustable headrest. This is optional and fits onto the backrest frame of the swivel chair. Upholstered in either black fabric or black leather.

**Guest chairs:****Seat:**

The seat on the guest sling chairs is made from moulded polyurethane foam seat, density 30 kg/m<sup>3</sup>.

**Backrest:**

The backrest is made from open mesh fabric stretched over a steel frame.

**4 leg frame:**

The 4-leg chairs are supported by a chrome plated precision tubular steel frame, 25 Ø x 2 mm, fitted with PP armrests.

**Standard:**

The swivel chair is in the process of certification under standard UNE-EN 1335-3.  
The sling chair is in the process of certification under standard UNE-EN 13761:2003.

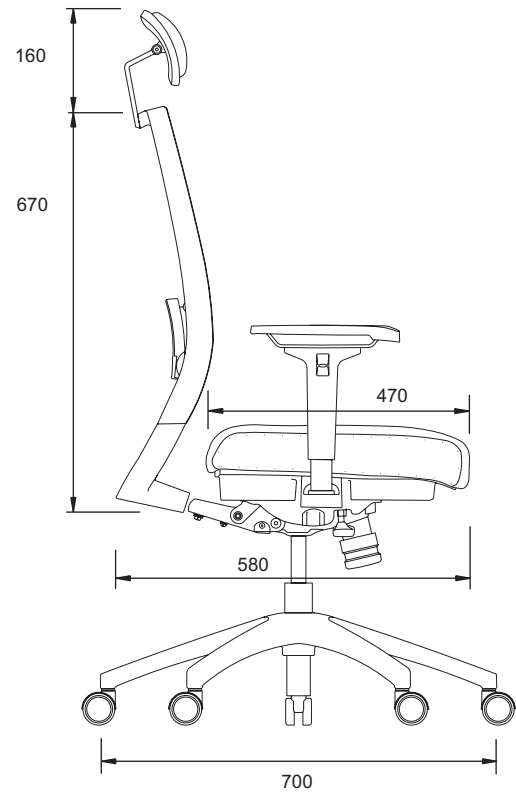
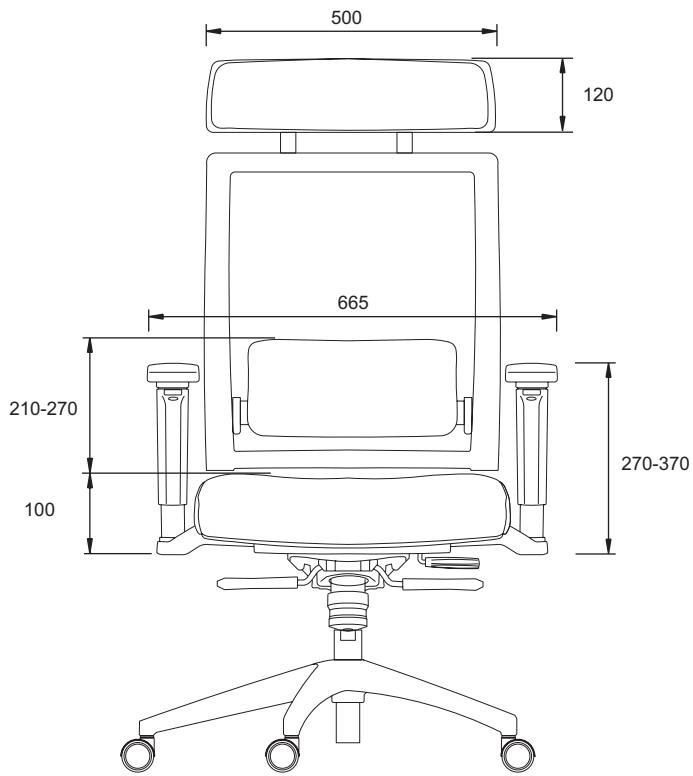

M<sup>3</sup>: 0,35  
Kg: 24

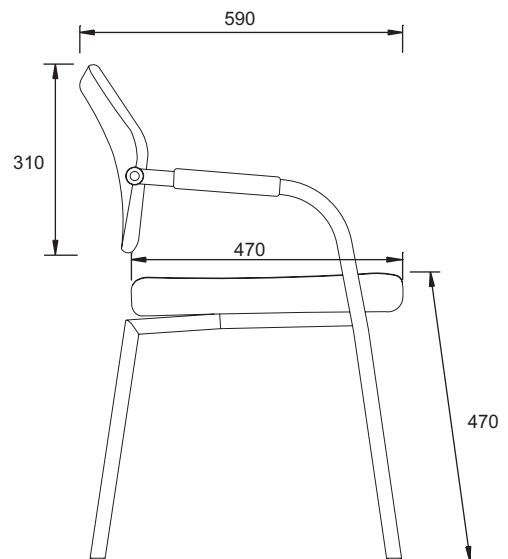
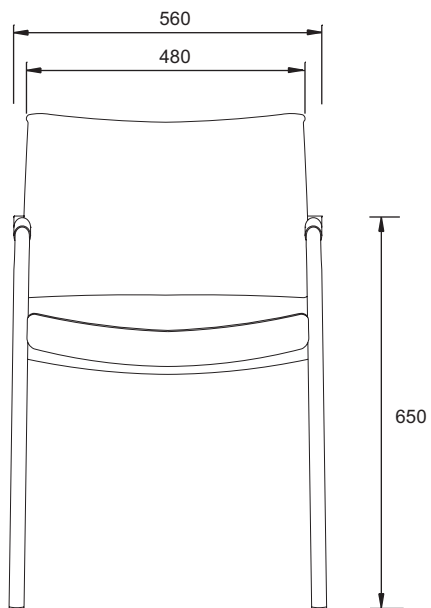

M<sup>3</sup>: 0,25  
Kg: 14